

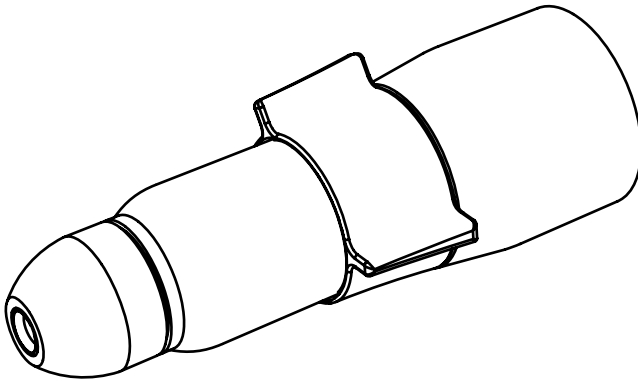

## **BUCK® | PODOLOG NOVA**

### Interchangeable chuck

for item. no. 11000B PODOLOG NOVA 1\*  
item no. 11000A PODOLOG NOVA 2  
item no. 1100001 PODOLOG NOVA 3  
item no. 1140001 PODOLOG NOVA 3s



\* Only suitable for converted NOVA 1 devices with NOVA 2 handpiece.



**EN** 8015702 | Instructions for use for PODOLOG NOVA interchangeable  
chuck | REV 04 | Revision status 17/03/2022

**CE 0483**

## RUCK Interchangeable chuck for PODOLOG NOVA

- Diese Gebrauchsanweisung können Sie in weiteren Sprachen unter nachfolgendem Link herunterladen oder telefonisch anfordern.
- Tämän käyttöohjeen voitte ladata useilla eri kielillä seuraavasta linkistä tai pyytää tietoja puhelimitse.
- Puede descargar las instrucciones de uso en diferentes idiomas en el siguiente enlace o bien solicitarlas por teléfono.
- Te instrukcję użytkowania można pobrać w innych językach klikając poniższy link lub zamówić telefonicznie.
- Tento návod je také k dispozici v jiných jazycích. Použijte prosím následující odkaz ke stažení návodu nebo si je vyžádejte telefonicky.
- Šo lietošanas instrukciju citās valodās iespējams lejuplādēt zemāk norādītajā saitē vai pieprasīt telefoniski.
- These instructions for use are also available in other languages. Please use the following link to download the instructions or request them on the phone.
- Questo manuale è disponibile anche in altre lingue. Lo si può scaricare utilizzando il seguente link o richiederlo per telefono.
- 此說明書另有提供其他國家語言，請點擊此連結下載檔案，或透過電話詢問下載亦可。
- Ta navodila za uporabo v ostalih jezikih lahko prenesete prek naslednje povezave ali pa jih naročite prek telefona.
- Acest manual este disponibil si in alte versiuni de limba. Accesati link-ul urmator pentru a descarca manualul sau il puteti solicita telefonic.
- Ви можете загрузить настоящее руководство по эксплуатации на других языках по следующей ссылке или запросить его по телефону.
- Τις οδηγίες χρήσεως μπορείτε να τις βρείτε και σε άλλες γλώσσες, πατώντας στο παρακάτω link για να τις κατεβάσετε ή να τις ζητήσετε τηλεφωνικώς.
- U kunt de gebruiksaanwijzing in diverse talen downloaden onder de volgende link. U kunt de gebruiksaanwijzing ook telefonisch aanvragen.
- Le présent mode d'emploi est disponible aussi en autre langues. Veuillez utiliser le lien suivant pour le télécharger ou demandez-le par téléphone.
- Bu kullanim klavuzunu farklı dillerdede aşağıdaki bağlantıdan indirebilir yada telefon ile istiyebilirsiniz.
- Šią naudojimo instrukciją kitomis kalbomis galite parsisiųsti paspaudę toliau pateiktą nuorodą arba užsisakyti paskambinę telefonu.
- A használati utasítást további nyelveken a következı linkrıl tudja tölteni, vagy kérheti telefonon.
- ניתן להוריד חומאות שימוש אל בשפות אחרות מחקישור חבא או בנקש אותן במעצמות הסנסן.
- 여러 언어로 된 본 사용설명서를 다음 링크에서 다운로드하시거나 전화로 요청하실 수 있습니다.
- Hægt er að sækja þessar notkunarleiðbeiningar á öðrum tungumálum með eftirfarandi tengli eða panta þær símleiðis.
- Ezen kezelési útmutató további nyelveken a következı linken keresztül tölthetı le, vagy telefonon megkérhetı.
- この取扱説明書はその他の言語でも以下のリンクでダウンロードしていただくことが可能です。またはお電話でお問い合わせいただければご案内申し上げます。
- Du kan downloade denne brugsanvisning på andre sprog på følgende link eller bestille den telefonisk.
- Denne bruksanvisningen finnes på flere språk, og du kan laste den ned ved å trykke på lenken eller du kan ringe oss og be om å få den tilsendt.
- Цю інструкцію з експлуатації іншими мовами Ви можете завантажити за нижчезказаним посиланням або замовити по телефону.



1. hellmut-ruck.de
2. Search term: "1106701"
3. Downloads

<https://www.hellmut-ruck.de>  
1106701

Downloads  
80157xx\_GA\_Wechselspannfutter\_XX\_2022-xx-xx



**HELLMUT RUCK GmbH | Daimlerstr. 23 | DE-75305 Neuenbürg, Germany**  
**HELLMUT RUCK LTD | Raceside Barn, Kirksanton | Millom, GB-LA18 4NW**  
**hellmut-ruck.de**

This is a translation of the manufacturer's original operating instructions.

### Copyright

© 2022 HELLMUT RUCK GmbH. All rights reserved. This document must not be copied, edited, reproduced or translated without the prior, written permission of HELLMUT RUCK GmbH.

## Contents

Contents .....	3
Abbreviations and symbols.....	4
Safety instructions and scope of delivery.....	5
Replacing interchangeable chuck: removing handpiece sleeve .....	6
Replacing interchangeable chuck: removing fixing tape and clamping unit .....	7
Replacing interchangeable chuck: determining joint version .....	8
Replacing interchangeable chuck: mounting clamping unit .....	9
Replacing interchangeable chuck: mounting clamping unit .....	10
Replacing interchangeable chuck: mounting clamping unit and attaching the fixing tape .....	11
Replacing interchangeable chuck: screwing on handpiece sleeve .....	12
Cleaning and disinfection .....	13
Spare parts and disposal .....	14

### Declaration relating to these instructions for use

HELLMUT RUCK GmbH reserves all rights to modify and supplement these instructions for use. HELLMUT RUCK GmbH has taken great care to keep these instructions free of inaccuracies and omissions. Please contact us if you find any errors or inaccuracies. However, HELLMUT RUCK GmbH assumes no liability for mistakes in these instructions for use or consequential damage resulting from the provision of these instructions for use or their application when using the product.

These instructions for use must not be disseminated or supplemented without the express approval of HELLMUT RUCK GmbH.

The manufacturer cannot be made responsible for damage that is caused by use that deviates from the intended use or failure to comply with the safety instructions and warnings.

This product is a medical device.

### Abbreviations and symbols



**This symbol identifies a potential point of danger for people or for the device itself. It must be taken note of.**



**This symbol identifies useful advice.**  
**Additional information about the product and how to use it is provided here.**



**Observe the disposal notice**



### Safety notices



Please note: The replacement of the clamping unit described below does not replace the biennial maintenance of your PODOLOG NOVA by RUCK SERVICE.

Observe the manufacturer's specifications and instructions.



As contaminated dust particles can be released during the replacement procedure, please wear mouth protection. Disinfect the workstation and the device afterwards using a suitable surface disinfectant.

### Scope of delivery

**1x** instructions for use



**1x** interchangeable chuck

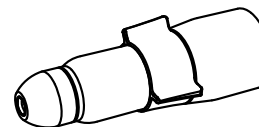

Item no. 1106401 interchangeable chuck for PODOLOG NOVA 1 and PODOLOG NOVA 2  
Item no. 1106701 interchangeable chuck for PODOLOG NOVA 3 and PODOLOG NOVA 3s

**1x** Fixing tape (located on the back of these instructions for use)



## ① Removing handpiece sleeve



Before exchanging the clamping unit, switch off the PODOLOG NOVA and pull the mains plug.

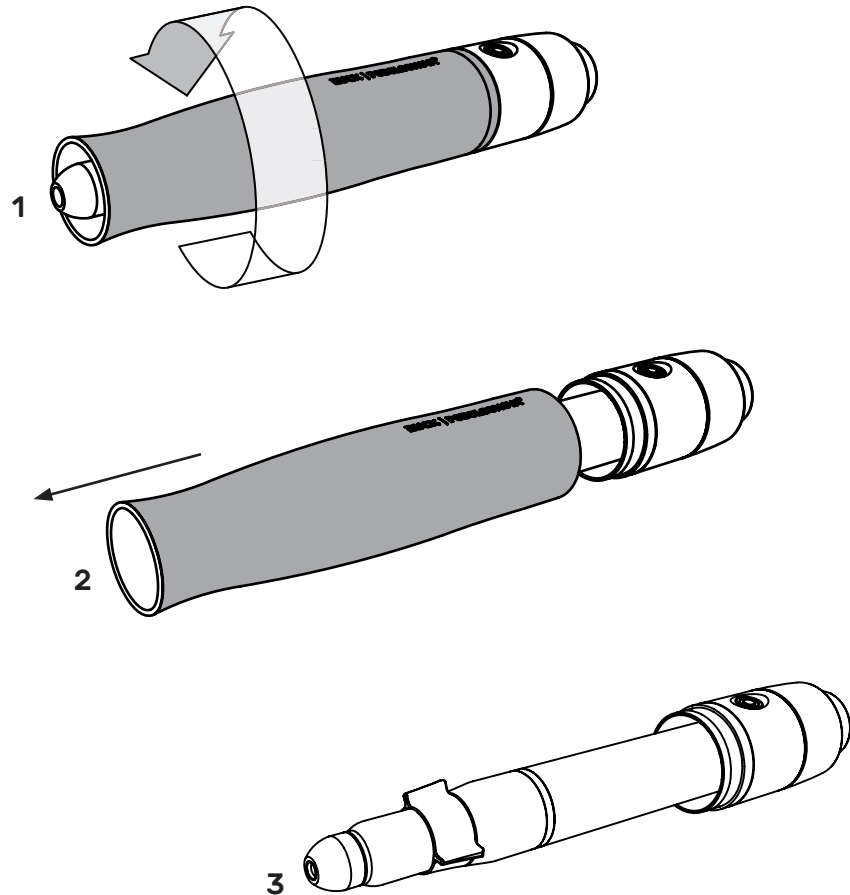

## ② Removing fixing tape

Any adhesive residues must be removed

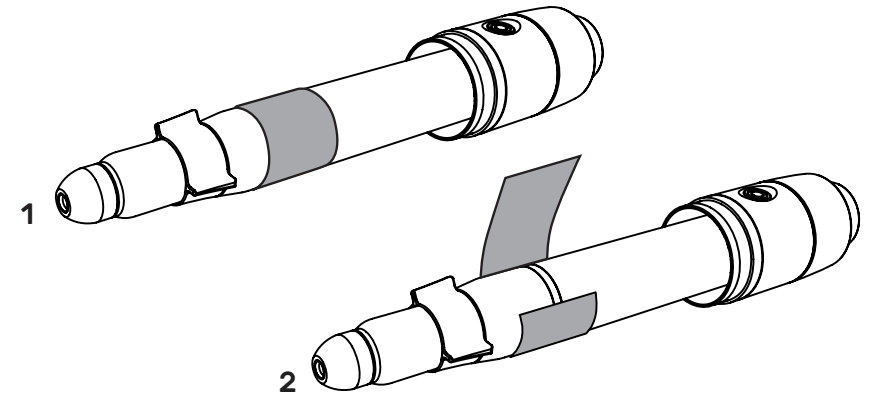

If the clamping unit is not secured by fixing tape, please contact RUCK SERVICE.

## ③ Unscrewing the clamping unit

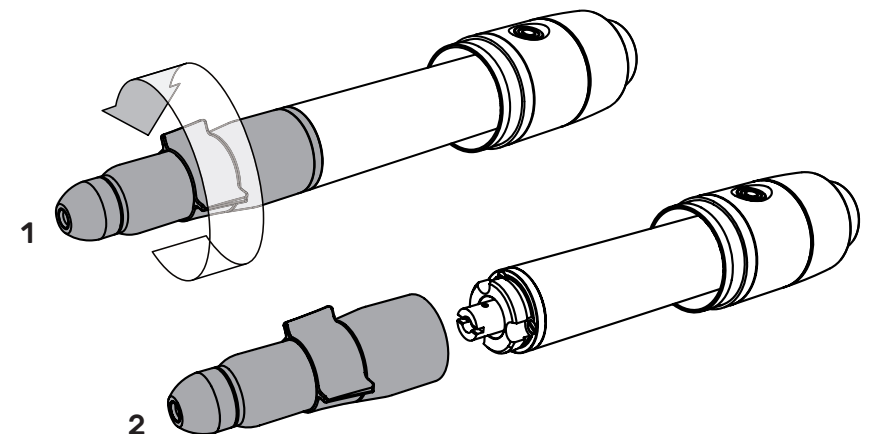

## ④ Determining joint version

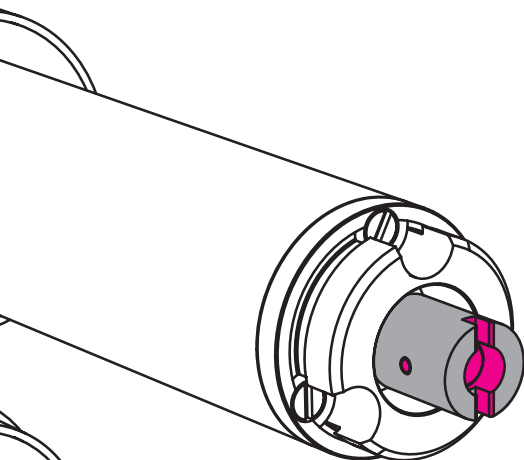

### Old universal joint

Go to section 5.1. (page 9)

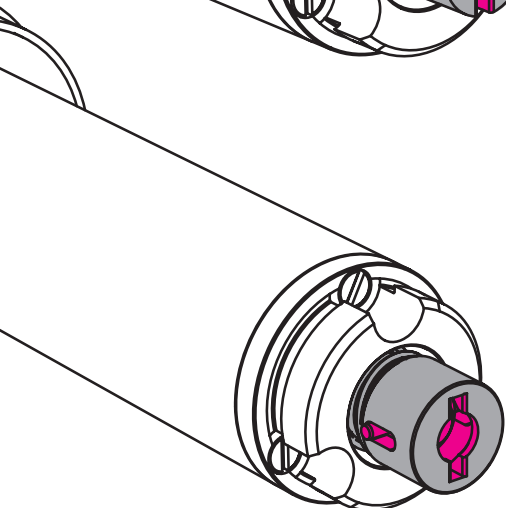

### New universal joint

Go to section 5.3. (page 11)

## ⑤ Mounting clamping unit

### 5.1. Mounting clamping unit – old universal joint



Please note that the components (A and B), shown in grey in the lower drawing, must interlock when the clamping unit is being screwed into the motor as shown in the figure.

**If this is not the case, the joint or the micro motor in the hand-piece can be destroyed when screwing in the clamping unit!**

To avoid damage when screwing in the clamping unit, please proceed as follows:

- 1.) Put the clamping unit on and carefully screw it in **without force**.
- 2.) If there is resistance shortly before the end when screwing in the clamping unit, which can only be overcome with additional force, components A and B do not fit into each other.  
**Under no circumstances should you continue to screw it in or use additional force!**  
Please proceed as described in point 5.2.
- 3.) If the clamping unit can be screwed in without difficulty, without resistance, the parts interlock correctly. You can now reattach the fixing tape as described in section 6.

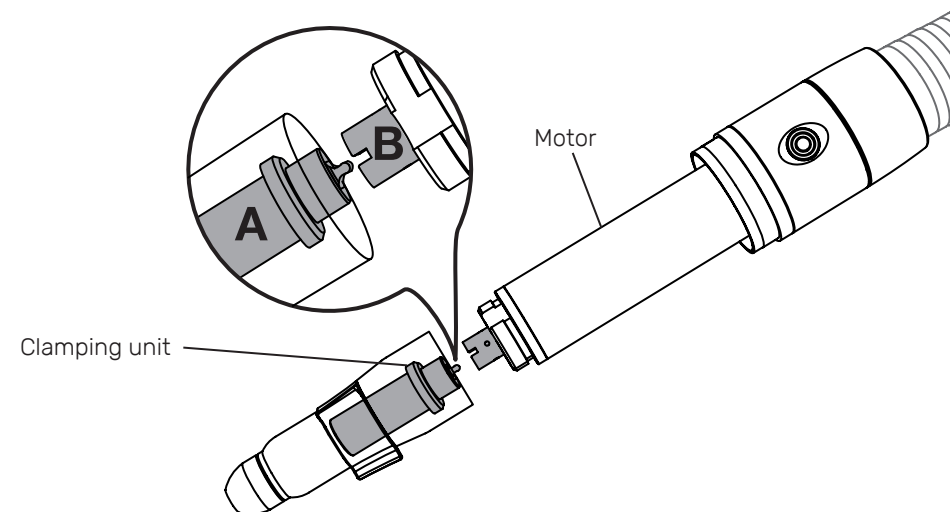

### 5.2. Resistance when screwing in the clamping unit

If the clamping unit cannot be completely screwed in without resistance, proceed as follows:

- 1.) Place any burr in the clamping unit.
- 2.) Unscrew the clamping unit by one rotation. Then rotate the burr a little bit further (approx. 1/4 rotation).
- 3.) Carefully screw in the clamping unit again. If components A and B fit together, the clamping unit can be screwed in easily, without resistance. If components A and B do not fit together, resistance can be felt again when screwing in. In this case, repeat the procedure starting from point 2. Possibly, several repetitions are needed before the components fit together.

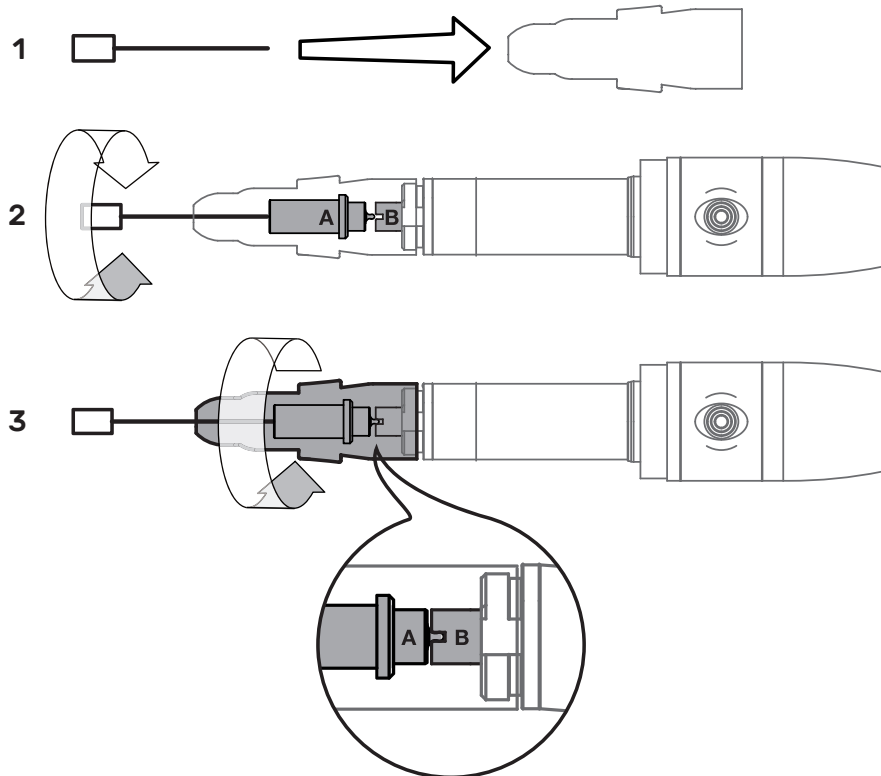

### 5.3. Mounting clamping unit – New universal joint

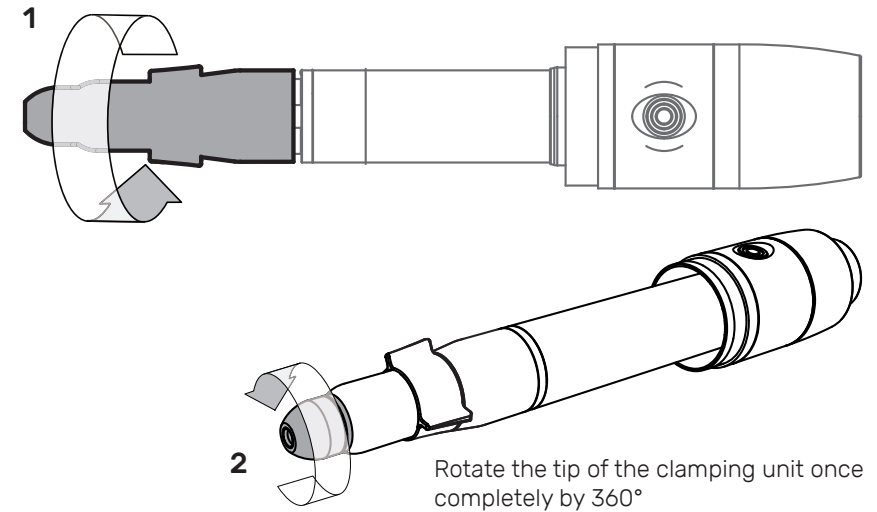

### ⑥ Attaching the fixing tape

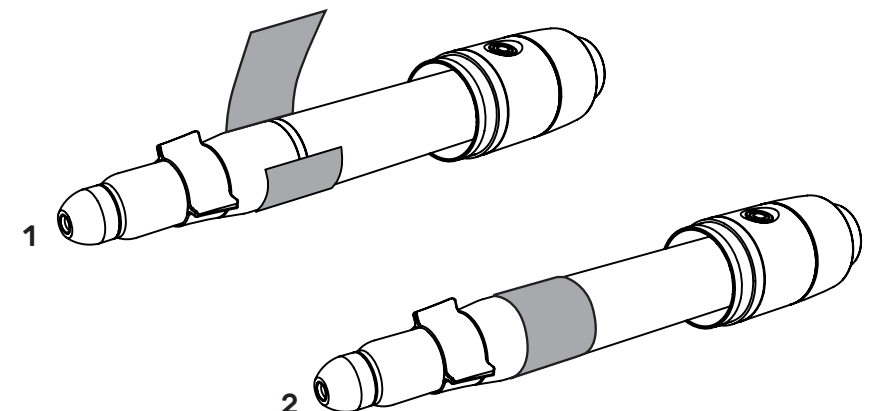

## ⑦ Screwing on handpiece sleeve

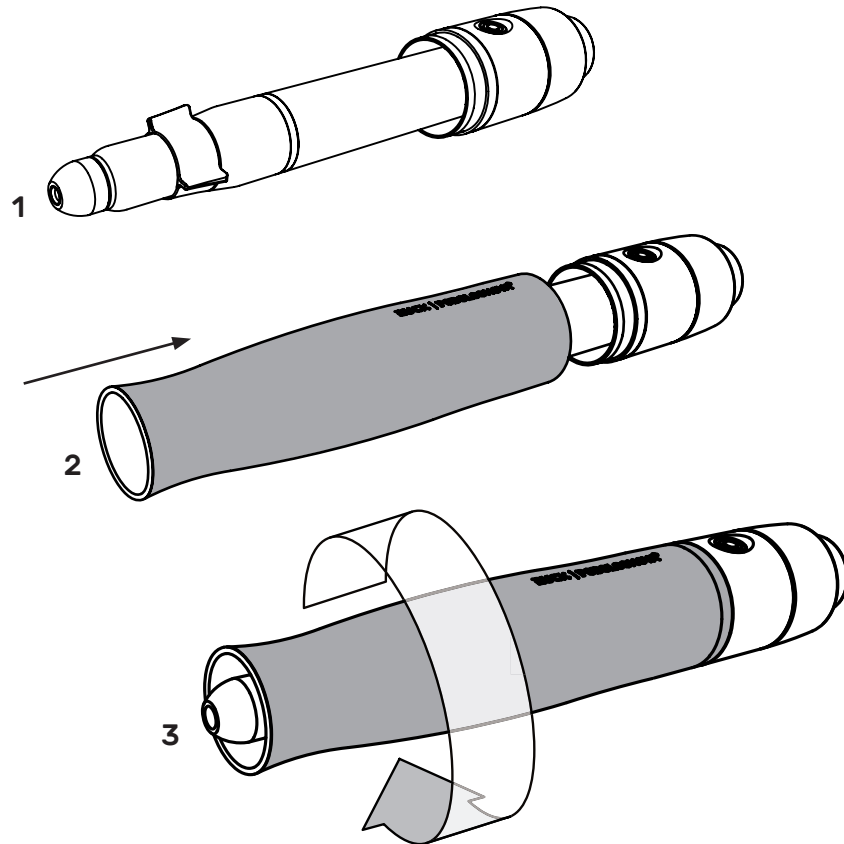

After assembling all the components as described, reconnect the PODOLOG NOVA to a power source.

Insert any burr and switch on the handpiece motor. The burr should run quietly and maintain its position in the handpiece.

If this is not the case, check whether the instructions in these operating instructions were observed when inserting the interchangeable chuck.

If you have any questions, contact RUCK SERVICE.

## Cleaning and disinfection

Disinfect the contact surfaces after each treatment with RUCK surface disinfection wipes, alcohol-free item no. 2966702 or item no. 2967002.

Please observe the exposure times of the disinfectants according to the product labelling.

Danger of damage due to improper care of surfaces. Do not use any concentrated disinfectants, solvents, cleaning agents or liquids that contain alcohol (>50 % alcohol content). Do not use spray disinfection.

Take great care to ensure that the cleaning utensils used are clean. If mineral contaminants such as grains of sand or dust are embedded in the cleaning agents, this can destroy the surface. Do not use any scouring agents, such as abrasive cleaners, cleaning sponges or similar items that may contain abrasive particles. Residues of leaked fluids must be removed from the surface immediately with a soft cloth.

For gentle cleaning of the surfaces, use a soft cotton cloth or the RUCK microfibre cloth which is gentle on surfaces (item no. 29616).

Caution: Other cleaning cloths with plastic fibres can have an abrasive effect and consequently they can damage the surface.

Over time, traces of use can appear on the surfaces. These are more or less noticeable depending on light incidence. They do not constitute a lessening of utility. As is the case with all surfaces over the long term, due to the wear involved in the daily routine of the medical practice, they cannot be avoided. Spots or stains caused by liquids that may corrode the surface (such as propolis, tea tree oil, cleaners that contain chlorine or similar substances) are categorically excluded from the warranty.



## Spare parts

Please contact **RUCK SERVICE** for spare parts.

Telephone +49 (0)7082 944 22 55

Fax +49 (0)7082 944 22 59

E-mail [service@hellmut-ruck.de](mailto:service@hellmut-ruck.de)

## Disposal



### Environmental hazard!

## Incorrect disposal endangers our environment



Please use available return and collection systems for disposing of the interchangeable chuck at the end of its service life.

To properly dispose of the interchangeable chuck, remove the black star bushing and throw it in the plastic waste. The remaining metal components are disposed of via the recycling bin or the scrap metal collection point at the recycling centre. The metal components can be separated according to type and returned to the material cycle in a professional manner.

[illegible]



HELLMUT RUCK GmbH  
Daimlerstrasse 23  
75305 Neuenbürg, Germany

Tel. +49 (0)7082 944 20  
Fax +49 (0)7082 944 22 22

E-mail: [kontakt@hellmut-ruck.de](mailto:kontakt@hellmut-ruck.de)  
Website: [hellmut-ruck.de](http://hellmut-ruck.de)



HELLMUT RUCK LTD  
Raceside Barn, Kirksanton  
Millom, GB-LA18 4NW